

HIGHWAY 119
UNINCORPORATED SHELBY COUNTY
ZONED A-1

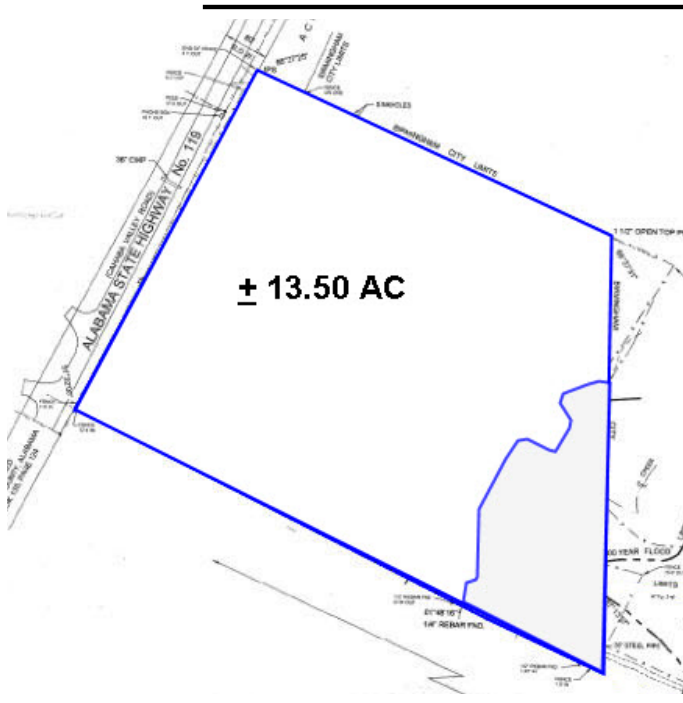

DANIEL
CORPORATION



- 1.5 miles from Highway 280
- Level site
- Excellent development opportunity with supporting demographics
- Located near entrances to Greystone and Brook Highland developments
- Utilities at property
- Possible subdivision

For More Information
Contact

CHRIS SCHMIDT
(205) 443-4561
cschmidt@danielcorp.com